

Bulletin #3
2019 100 Acre Wood Rally
March 5, 2019

To: All Competitors

Subject: Entry Limit

We have done some extra work and found that we can fit all of the currently paid teams into service. Some service spots will not be ideal and will be on grass or gravel. Entry is still closed but the wait list has been removed. The maximum number of teams we will now accept is 81. All teams on the wait list have been contacted. The Supplementary Regulations are revised as follows:

4.1 Entry Procedure:

Entries will be accepted for this rally beginning on January 14, 2019, and will not be charged late fees if full payment is received or postmarked no later than February 25, 2019. An 81 car limit will be employed based on order of receipt. The SxS Rally entry will be capped at 10 cars, counting toward the 81 total. The entry fee structure is listed in Section 4.2.

4.3 Withdrawal Policy:

4.3.1 Entries that are withdrawn before 23:59 CST on Tuesday, March 5, 2019 will have the entry fee refunded.

4.3.2 Entries that are withdrawn after 23:59 CST on March 5 and before the start of the rally will be refunded minus a \$100 processing fee. These withdrawals shall be made to the event chair or registrar. No refunds will be made after the start of the rally.

All teams currently entered that won't be able to make it are encouraged to withdraw as soon as possible by sending an email to curt@100aw.org

Due to the large entry this year, service space will be tight. Section 9.5 Trailers of the Supplementary Regulations is appended with the following:

9.5.1 Trailer parking in service: Teams that do not use their trailer to service their car are highly encouraged to park their trailer outside of their assigned service area. A designated area will be provided at the two service locations during the rally.

Preliminary service spots have been set and team numbers are shown on the attached service location maps.

Thank you,
Curt Faigle
Chairman

 Unassigned Service Spots

Overflow Service

HWY 8

Service Entrance & Exit

Two Way Spectator Traffic

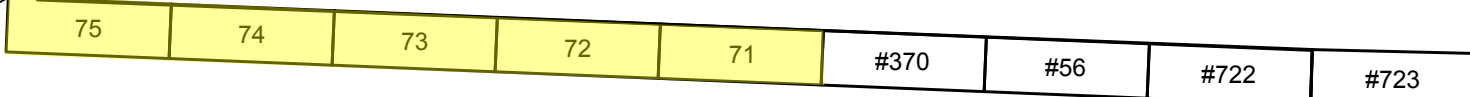
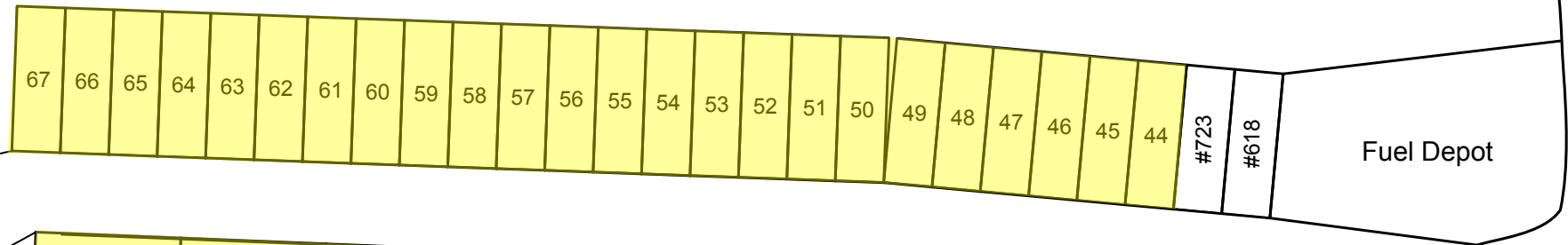

To Start of Super Special Stage #6

Spaces #1 - #29 are 25' x 40'
Spaces #30 - #75 are 20' x 60'

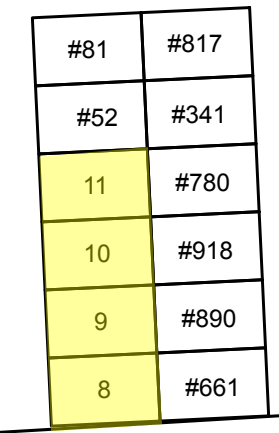
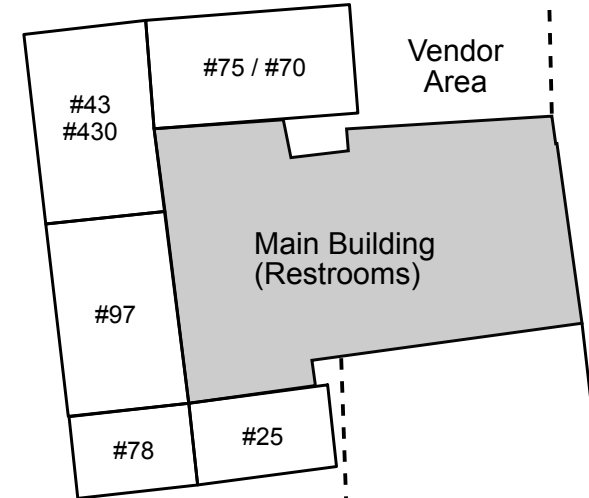
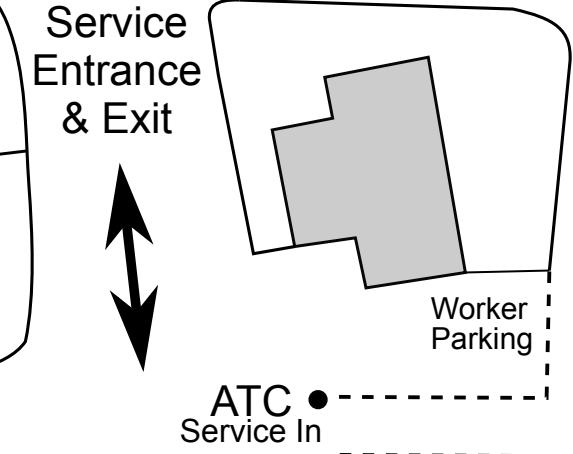
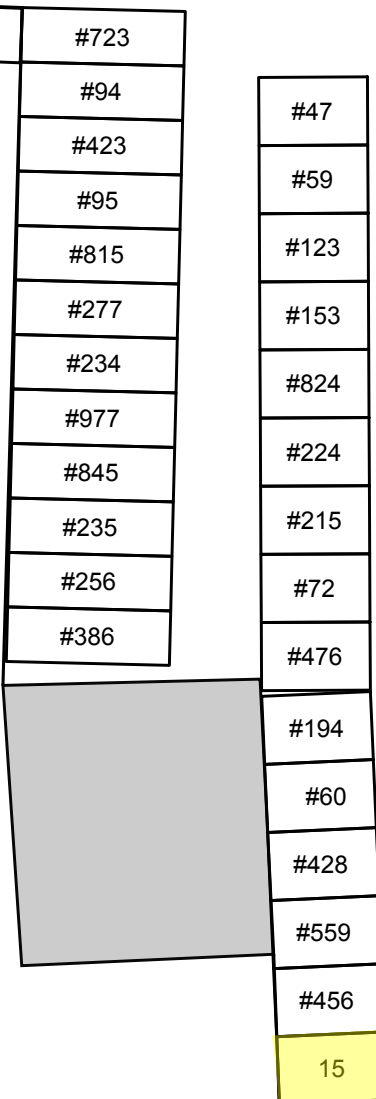

From Finish of Super Special Stage #6



Friday Service
Huzzah Valley
Assigned Service Map



Overview

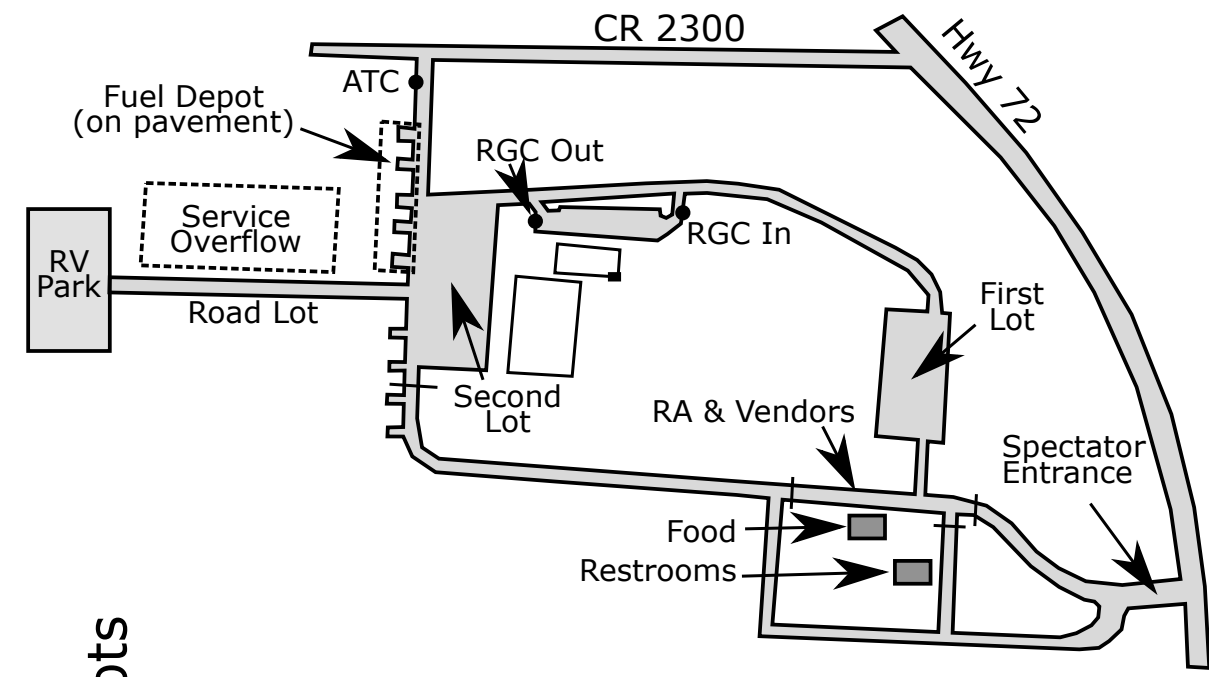

Second Lot

First Lot

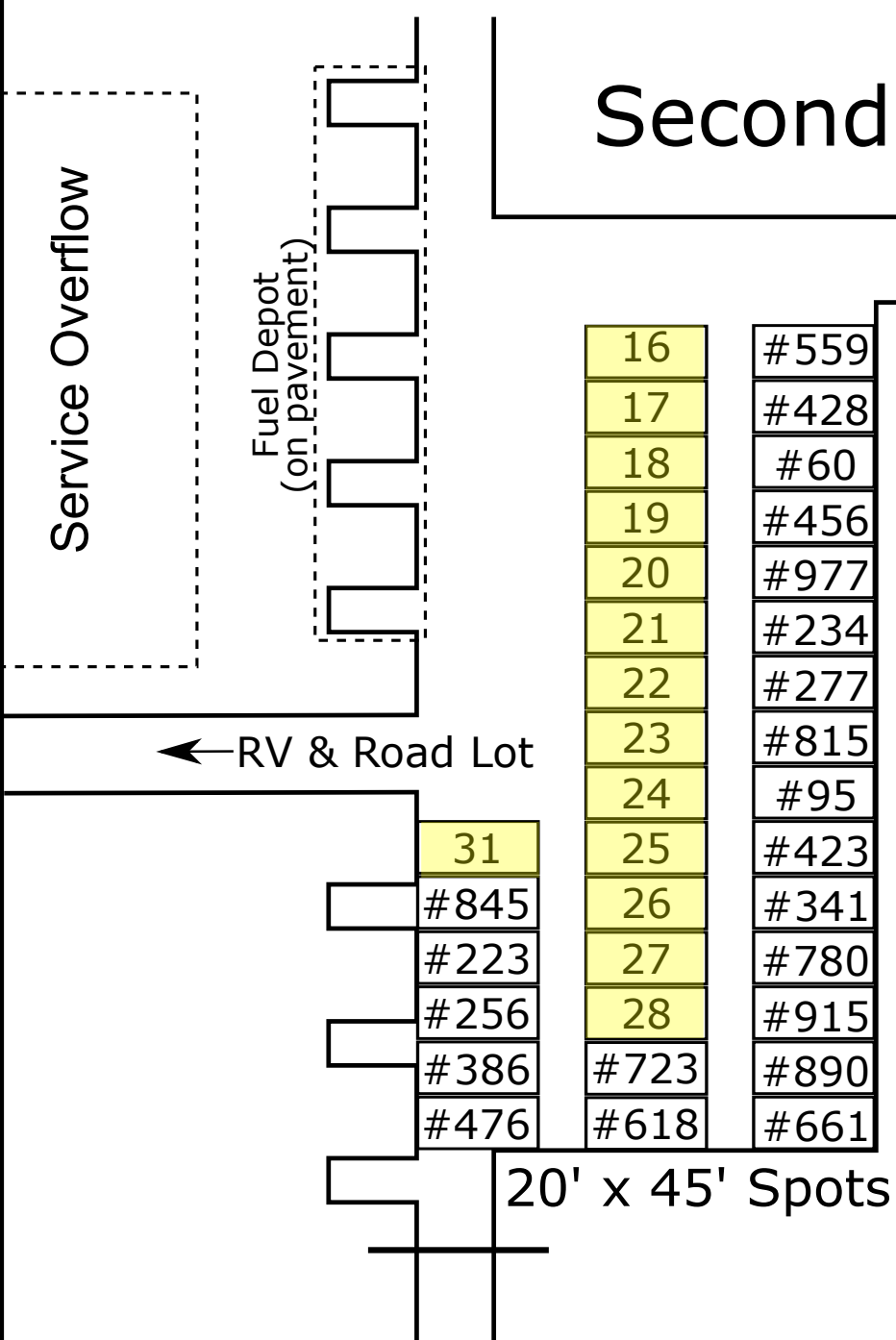

Normal 45' x 20' Spots	#56	Oversized 45' x 60' Spots
	#47	
	#59	
	#123	
	#153	
	#81	
	#817	
	#94	
	#824	
	#224	
	#215	
	#72	
	65	
	66	
	71	
72		

Unassigned Service Spots

Road Lot

37	38	39	40	41	42	43	44	45	46	47	48	#370	#723	#722
----	----	----	----	----	----	----	----	----	----	----	----	------	------	------

20' x 60' Spots